



CE UK EAC  
CA EAC

04584744  
Edition 8  
January 2022

# Air Impact Wrench

## 261 and 271 Series

---

# Product Information

- |   |  |
|---|--|
| <b>EN</b> Product Information           | <b>CS</b> Specifikace výrobku                |
| <b>ES</b> Especificaciones del producto | <b>ET</b> Toote spetsifikatsioon             |
| <b>FR</b> Spécifications du produit     | <b>HU</b> A termék jellemzői                 |
| <b>IT</b> Specifiche prodotto           | <b>LT</b> Gaminio techniniai duomenys        |
| <b>DE</b> Technische Produktdaten       | <b>LV</b> Ierīces specifikācijas             |
| <b>NL</b> Productspecificaties          | <b>PL</b> Informacje o Produkcie             |
| <b>DA</b> Produktspecifikationer        | <b>BG</b> Информация за Продукта             |
| <b>SV</b> Produktspecifikationer        | <b>RO</b> Informații privind produsul        |
| <b>NO</b> Produktspesifikasjoner        | <b>RU</b> Технические характеристики изделия |
| <b>FI</b> Tuote-erittely                | <b>ZH</b> 产品信息                               |
| <b>PT</b> Especificações do Produto     | <b>JA</b> 製品仕様                               |
| <b>EL</b> Προδιαγραφές προϊόντος        | <b>KO</b> 제품 상세                              |
| <b>SL</b> Specifikacije izdelka         | <b>HR</b> Podaci o proizvodu                 |
| <b>SK</b> Špecifikácie produktu         |  |



Save These Instructions

**IR** Ingersoll Rand®

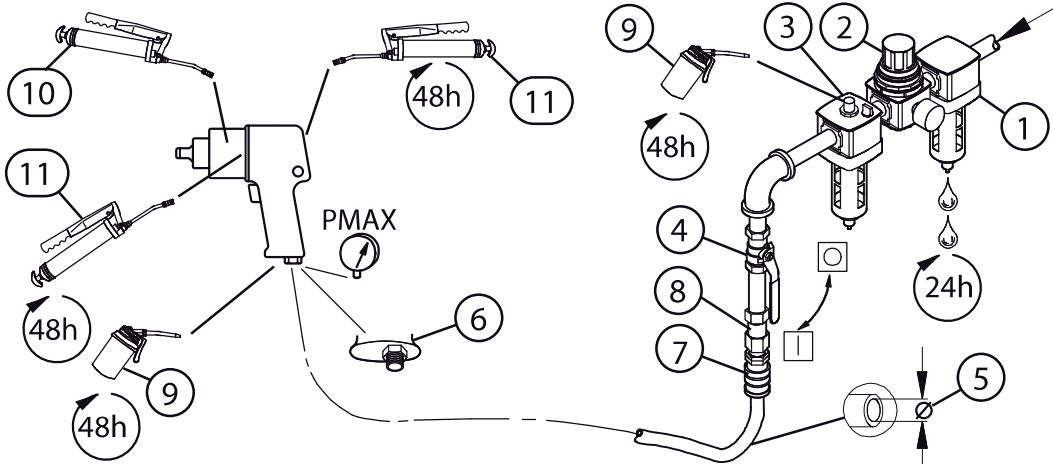

(Dwg. 47132600)

①②③		⑤	⑥	⑦	⑨	⑩	⑪		
IR # - NPT	IR # - BS	inch (mm)	NPT	IR #	IR #	IR #	cm <sup>3</sup>	IR #	cm <sup>3</sup>
C38341-810	C383D1-810	1/2 (13)	3/8	MSCF43	10	105-1lb	4	105-1lb	4

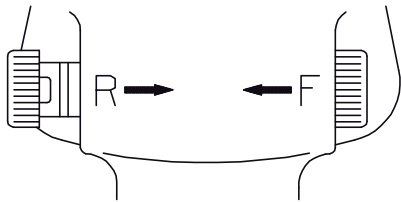

(Dwg.TPD1248)

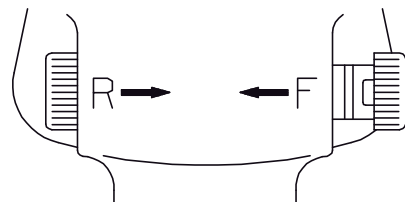
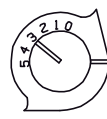

(Dwg.TPD1249)

## Product Safety Information

### Intended Use:

These Air Impact Wrenches are designed to remove and install threaded fasteners.

**For additional information, refer to Product Safety Information Manual Form 04580916.**

Manuals can be downloaded from [ingersollrand.com](http://ingersollrand.com)

## Power Management System

For models that include a power management system, the system allows operator reduction of maximum output power in either the forward or the reverse direction.

**For reduced power in the forward direction and full power in the reverse direction**, push the reverse valve inward on the right side of the tool and rotate the reverse valve until the notch on the right side aligns with the desired number on the right side. This provides reduced power in forward but full power in reverse when the reverse valve is pushed in the opposite direction. (See TPD1248 on page 2.)

**For reduced power in the reverse direction and full power in the forward direction**, push the reverse valve inward on the left side of the tool and rotate the reverse valve until the notch on the left side aligns with the desired number on the left side. This provides full power in forward but reduced power in reverse when the reverse valve is pushed the opposite direction. (See TPD1249 on page 2.)

**For full power in both directions**, rotate the Reverse Valve until the notch on each end of the Reverse Valve aligns with 5 on each side of the housing.

The power level indicators (See TPD1248 and TPD 1249) are for reference and **DO NOT** indicate a specific power. The power output can be further reduced in forward or reverse by using the variable throttle.

## Product Specifications

Model	Style	Drive		Impacts per min.	Recommended Torque Range ft-lb (Nm)	
		Type	Size		Forward	Reverse
261, 261-EU	Pistol	Square	3/4"	1,000	200-600 (271-813)	200-600 (271-813)
261-3, 261-3-EU	Pistol	Square extended	3/4" x 3"	1,000	200-600 (271-813)	200-600 (271-813)
261-6, 261-6-EU	Pistol	Square extended	3/4" x 6"	1,000	200-600 (271-813)	200-600 (271-813)
271, 271-EU	Pistol	Square	1"	1,000	100-750 (136-1017)	100-750 (136-1017)

Model	Sound Level dB(A) (ISO 15744)		Vibration (m/s <sup>2</sup> ) (ISO 28927)	
	† Pressure (L <sub>p</sub> )	‡ Power (L <sub>w</sub> )	Level	*K
261, 261-EU	98.1	109.1	10.4	1.3
261-3, 261-3-EU	98.1	109.1	10.4	1.3
261-6, 261-6-EU	98.1	109.1	10.4	1.3
271, 271-EU	98.1	109.1	13.2	1.1

† K<sub>pA</sub> = 3dB measurement uncertainty  
 ‡ K<sub>wA</sub> = 3dB measurement uncertainty  
 \*K= Vibration measurement uncertainty

 **WARNING**

**Sound and vibration values were measured in compliance with internationally recognized test standards. The exposure to the user in a specific tool application may vary from these results. Therefore, on site measurements should be used to determine the hazard level in that specific application.**

**Installation and Lubrication**

Size air supply line to ensure tool’s maximum operating pressure (P<sub>MAX</sub>) at tool inlet. Drain condensate from valve(s) at low point(s) of piping, air filter and compressor tank daily. Install a properly sized Safety Air Fuse upstream of hose and use an anti-whip device across any hose coupling without internal shut-off, to prevent hose whipping if a hose fails or coupling disconnects. See drawing 47132600 and table on page 2. Maintenance frequency is shown in a circular arrow and defined as h=hours, d=days, and m=months of actual use. Items identified as:

- 1. Air filter
- 2. Regulator
- 3. Lubricator
- 4. Emergency shut-off valve
- 5. Hose diameter
- 6. Thread size
- 7. Coupling
- 8. Safety Air Fuse
- 9. Oil
- 10. Grease - during assembly
- 11. Grease - through fitting

**Parts and Maintenance**

When the life of the tool has expired, it is recommended that the tool be disassembled, degreased and parts be separated by material so that they can be recycled. Original instructions are in English. Other languages are a translation of the original instructions. Tool repair and maintenance should only be carried out by an authorized Service Center. Refer all communications to the nearest **Ingersoll Rand** office or distributor.

---

**Notes:**

---

**Notes:**

---

**Notes:**

[ingersollrand.com](https://www.ingersollrand.com)

© 2022 *Ingersoll Rand*

